

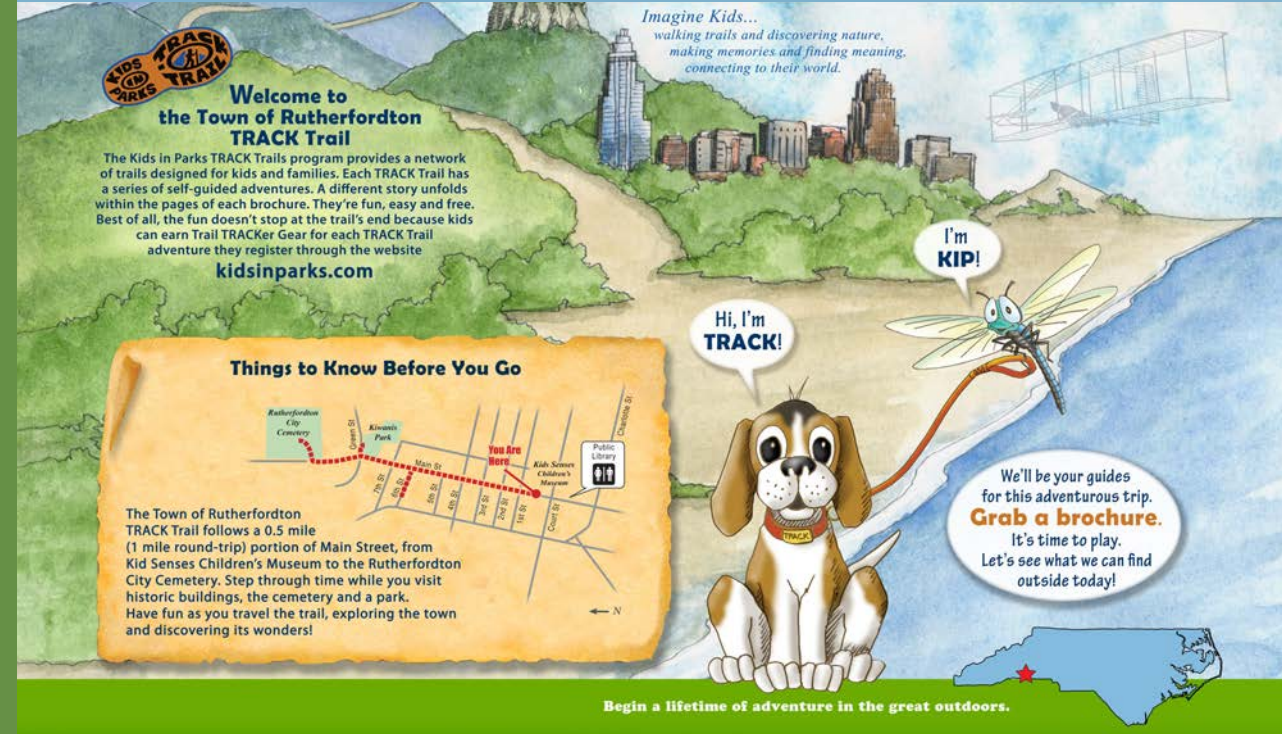

THE GOLD MILE



PURPLE MARTIN GREENWAY



KID'S MAIN STREET SAFARI



HISTORIC DOWNTOWN WALKING TOUR



Rutherfordton has a long and rich history full of intrigue, mystery and of course, gold. Many of the downtown buildings and homes stand as they did close to 200 years ago, and now you can tour them as you stroll through the streets of Rutherfordton and explore:

- The home of Christopher Bechtler; jeweler, gunsmith and minter of currency that was once preferred over that of the U.S. Mint.
- The path of the Overmountain Men on their way to the battle of Kings Mountain.
- The only remaining cluster of antebellum homes in the southern foothills of North Carolina.
- The final resting place of Civil War soldiers.

More History Online
Can't get enough? You're in luck, this entire tour is available online with additional pictures and extended history about each point of interest. You can even follow along as you walk, using your smartphone to scan the QR code on the plaque in front of each property.

View online at:
RutherfordtonTrails.com



Christopher Bechtler minted America's first one-dollar gold coin, in 1832, almost 17 years before the U.S. Mint made one of their own. The Gold Mile is a commemorative trail around downtown Rutherfordton that begins at the Bechtler House on W. 6th Street, and makes its way through the boutiques and businesses on Main Street.

The trail is marked by replica Bechtler one-dollar gold coins donated by those who support the rich history of Rutherford County.



Although the coins are not real gold like the original, they are crafted by a local artist to resemble Bechtler's famous one-dollar coin. Each one is hand-made and customized with a dedication message. If you are interested in leaving your mark on Rutherford County and becoming a part of the Gold Mile, you can pick up a donation form at the Bechtler House or online at VisitNCGold.com.

Named after the Purple Martin bird that appeared on General Griffith Rutherford's family crest, the Purple Martin Greenway is Rutherfordton's first natural trail system. Along this trail you can explore wildlife, creeks, waterfalls and local plant life. The trail is bike, kid and pet friendly as well as handicap accessible.

Located just off US Hwy 221, south of downtown Rutherfordton, Phase 1 opened in the fall of 2015 and



includes an easy one-mile stroll along Cleghorn Creek complete with picnic tables and a waterfall. Phase 2 is set to be completed by summer 2016 and will include an additional half-mile trail. Both trails will feature creative works from local artists that include interesting facts about the town's history.

Looking for more fun? Pick up an Adventure Guide at most downtown retailers.

The Kid's Main Street Safari through downtown Rutherfordton is the first of its kind. Usually occurring off the beaten path, even Kids in Parks couldn't ignore how fun it is to explore a historic downtown. This trail is jam packed with activities for kids of all ages. There are games, tree climbing, gold hunting and a search that leads you through a Civil War cemetery, just to name a few of the highlights.

The trail starts at either Kiwanis Park or KidSenses Children's InterACTIVE Museum and teaches kids about history and nature along the way. As an added bonus, kids can receive prizes for completing the trail and logging their adventures online at kidsinparks.com. Don't forget to visit MyRutherfordton.com for other fun activities for kids in and around town.

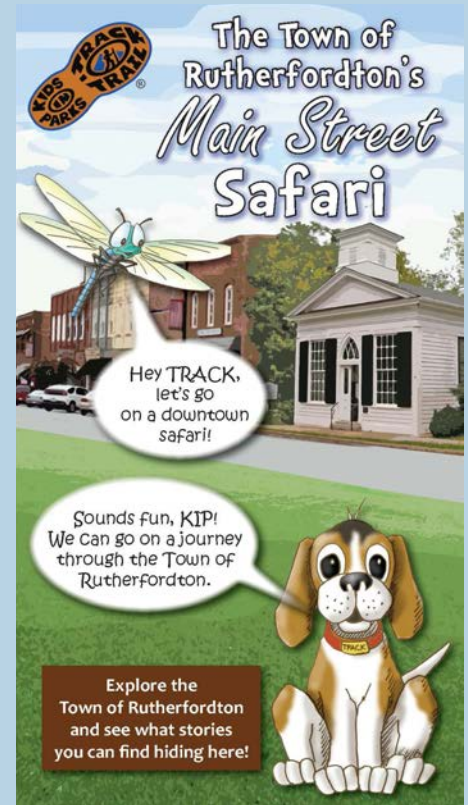



Town Mural (corner of Main and 1st St.)

Take a walk through our quaint downtown streets and explore our network of trails that are both beautiful and historic. The scenic views of the Blue Ridge Mountains serve as your backdrop while antebellum homes, gold trails and safari maps act as your guides. Spend the day, stay for the weekend and get to know Rutherfordton and all it has to offer!







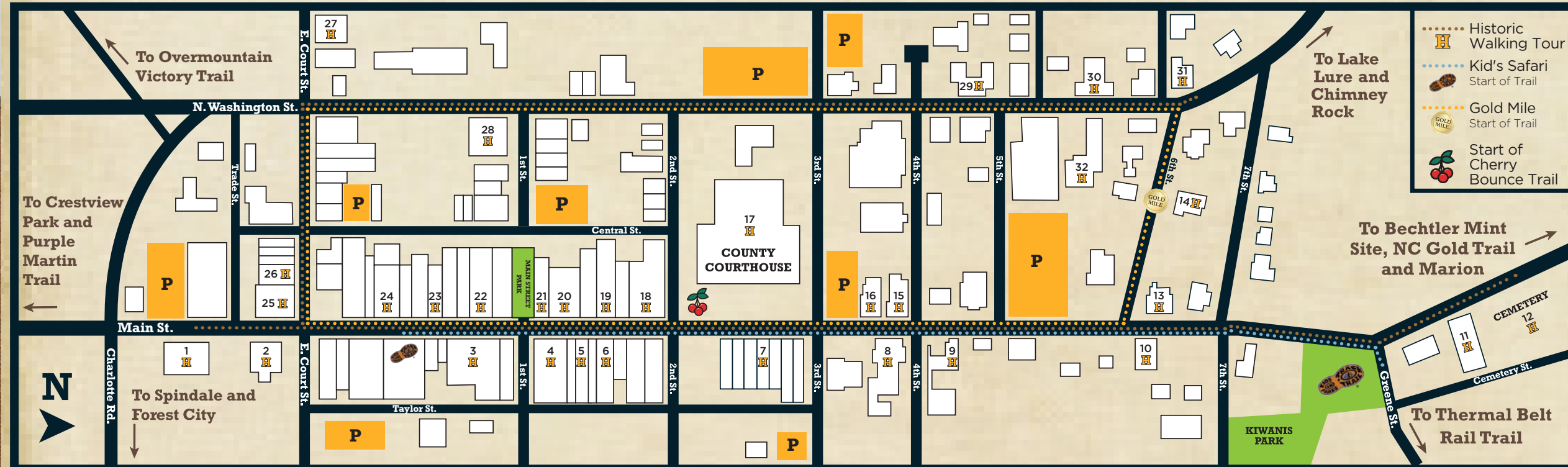



Rutherfordton
NORTH CAROLINA

© 2016 Town of Rutherfordton
Special thanks to the following people for providing both current and historical photos; Robin Spence Lattimore (Town Historian), Anne Strupp, Ron Giles, Dorothy Littman Ziesis, Louis Nanney Jr., Alex and Jane Bell, and Jane Simpson.

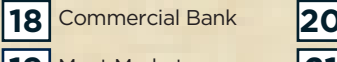

- Historic Walking Tour
- Kid's Safari Start of Trail
- Gold Mile Start of Trail
- Start of Cherry Bounce Trail

 1 Norris Public Library Built in 1933 it was named after the Norris family whose daughters established the library in 1921.	 5 Citizens Bank/Union Trust Once a focal point of downtown, the Ionic columns and granite are gone and it sits vacant awaiting a new tenant to claim its history.	 9 First Methodist Church Established in 1825, the current brick structure dates back to 1925 and features a five story steeple that sets it apart from other churches.	 13 Holly Hill - 1836 This Greek Revival style home was built in 1836 by James Miller and is one of the oldest private residences in town.	 22 Tanner Once home to Keeter Hardware it is now home to one of the first textile manufacturers in the area and sells high-end women's clothing.	 29 Hardin House - 1879 This two-story Queen Anne style house was built for Sheriff W.I. Hardin. It was later purchased by the Powers Family in 1943.
 2 Woodrow Jones This Georgian-Revival federal building was built in 1931 and served as a post office. Today it houses businesses and a welcome center.	 6 Professional Surveying Although its previous tenants are unknown, today's owner displays his deep appreciation of history with treasures of the past you have to see.	 10 St. John's Episcopal Established in 1847, today this church is owned by the Rutherfordton County Historical Society.	 14 Bechtler House Built in 1837, it was home to Christopher Bechtler who minted the first \$1 gold coin and operated a private mint in the 1830s.	 23 The Gallery Erected in 1924, this is one of the oldest downtown buildings and was home to businesses like McDaniel Sanders Co. and the Bee Hive.	 30 Rucker House - 1858 This Gothic Revival home highlights steep pitch gables and dormers and a unique ceiling inside painted by a traveling artist in 1890.
 3 Hill's Hardware Part of this building was once the Southern Hotel. In fact, the grand staircase that led guests to their rooms in 1910, still stands today.	 7 LuRe Cafe Pronounced by locals as Lou Ray, it was a favorite hot spot for lunch and dinner back in 1920.	 11 St. Francis Episcopal Built in 1899, it is a fine example of Gothic Revival architecture. Three of the memorial stain glass windows were crafted by Tiffany & Co.	 15 Carrier House - 1835 The oldest of two homes Harvey Carrier built for his family. Built in the Federal style, shingled gables & sawnwork were added post Civil War.	 24 Opera House Once home to an Opera House in 1895, the first Commercial Bank of Rutherfordton and later Carson Furniture Company.	 31 Lynch House - 1870 This Victorian period home is designed with wrap-around porches, chippendale railings and gables with mousetooth shingles.
 4 Victorian Lace Built in 1920, this building served as Littman's Economy Store. Today, it is a bustling antique business that pays homage to simpler times.	 8 First Baptist Church Organized in 1851, the current building, constructed in 1920, features stunning stain glass windows and Ionic columns.	 12 Rutherfordton Cemetery The earliest legible headstones date back to the 1830s and include the graves of Civil War soldiers and citizens from all walks of life.	 16 Carrier House - 1879 This home was built for Carrier's daughter in 1879 and now serves as a bed and breakfast for weary travelers looking for a good nights sleep.	 25 Levi Department Store Built by Myer Levi in 1888 for his retail business, it later included the Levi Bank. The third floor was added in 1900.	 32 Presbyterian Church Organized in 1834, an earlier wood structure was built in 1877 and replaced by the current building in 1952.

 17 Rutherford Court House Completed in 1926, it was designed by Louis H. Asbury. The classical stone veneer building features a two-story portico.	 26 Sylvan Theatre Built in 1932, "Gone with the Wind" was shown to a sold out crowd for three weeks in 1939.
 From Historic Parades to New Traditions Since 1797, downtown Rutherfordton has always been a favorite gathering place for festivals, reunions and any reason to celebrate. Today, its still serves as a hot spot for meeting friends, enjoying live music, and cheering on local race teams in the annual soap box derby "Race for the Gold!"	 The Cedar Inn - 1860 Built by M.L. Mitchell it housed one of the first pharmacies, and operated as a successful boarding house for over 100 years. It was purchased as a private residence in 1986.
 18 Commercial Bank	 20 Twitty Drug Store
 19 Meat Market	 21 Dixon Hardware



Explore Rutherfordton

A trail guide to adventure, history, and fun!

NATURE

GOLD

KID'S SAFARI

HISTORY